

## SINGLE SIDED SAFETY BARRIER ON GROUND - "H1-A-W6" ( B21300)

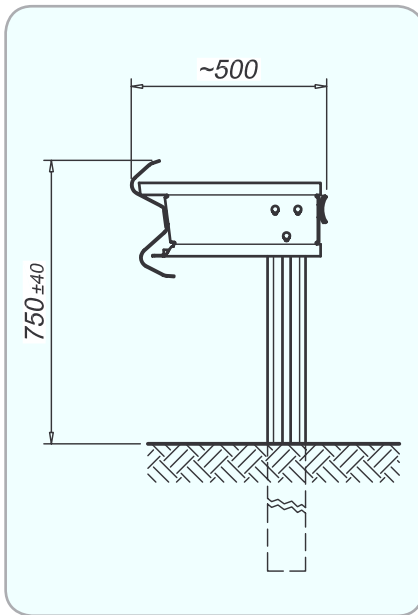

### Performance

Containment level	H1
Acceleration Severity Index "ASI"	A
Working width	W6 (1.59m)
Extreme lateral position of the vehicle	2,08 m

### Characteristics

Height out of ground	750 mm
Transversal overall dimensions	500 mm
Centre to centre between posts	2000 mm
Tested minimum length	80,40 m

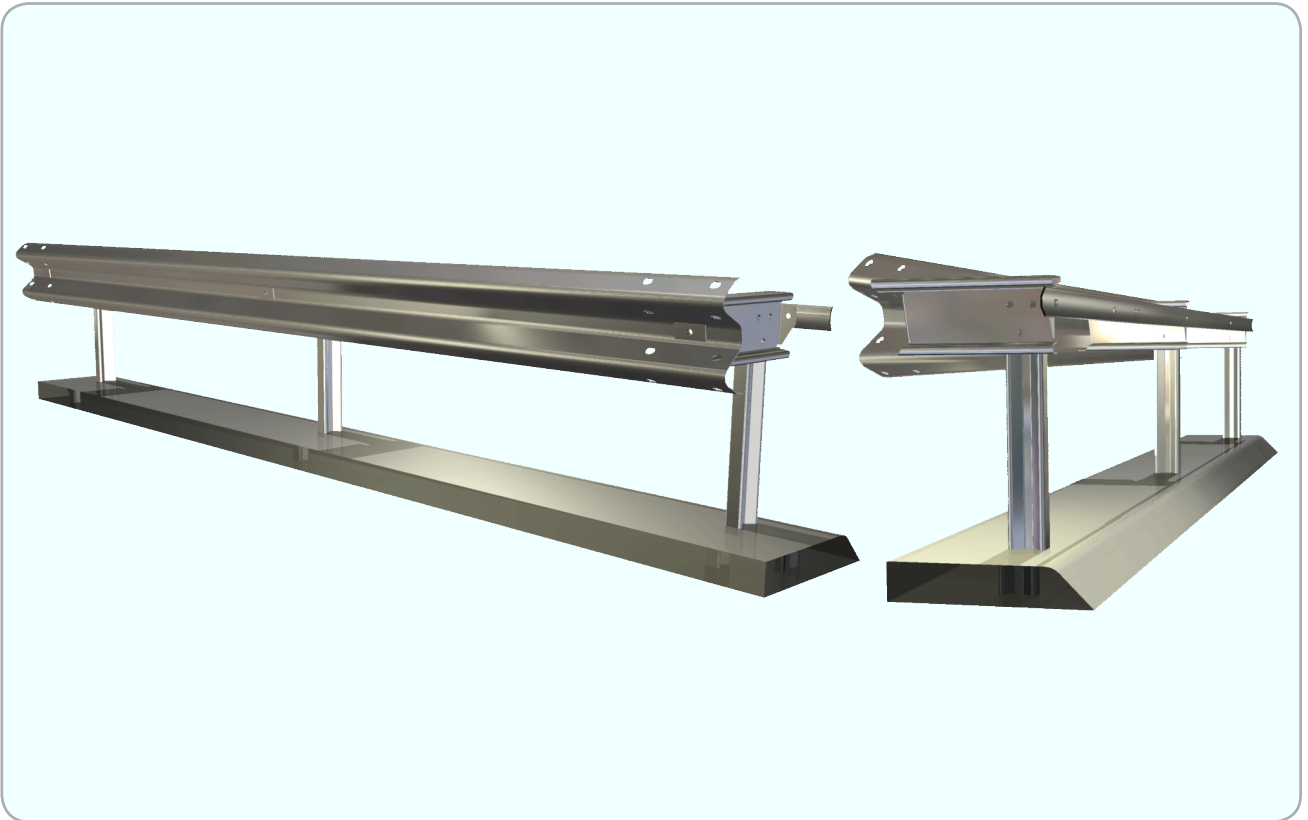

### Description

Supply and erection of 2-waves safety barrier, thickness 3,0 mm, SIGMA posts 100x55x4.2, h. 1900 mm, the posts are driven into the ground every 2000 mm, RAL spacers 480x194x3mm, connection sleeve 113x68x4, rear rail 70x5 mm, nuts and bolts and reflectors.

S235-275-355JR steel in quality-according EN 10025

Hot dip galvanization according EN ISO 1461

Nuts and bolts according EN ISO 898 - EN 20898 - UNI 3740/6

All particulars are in accordance with crash tests requirements.

Revision 1 of 17/09/2008

### Elevation

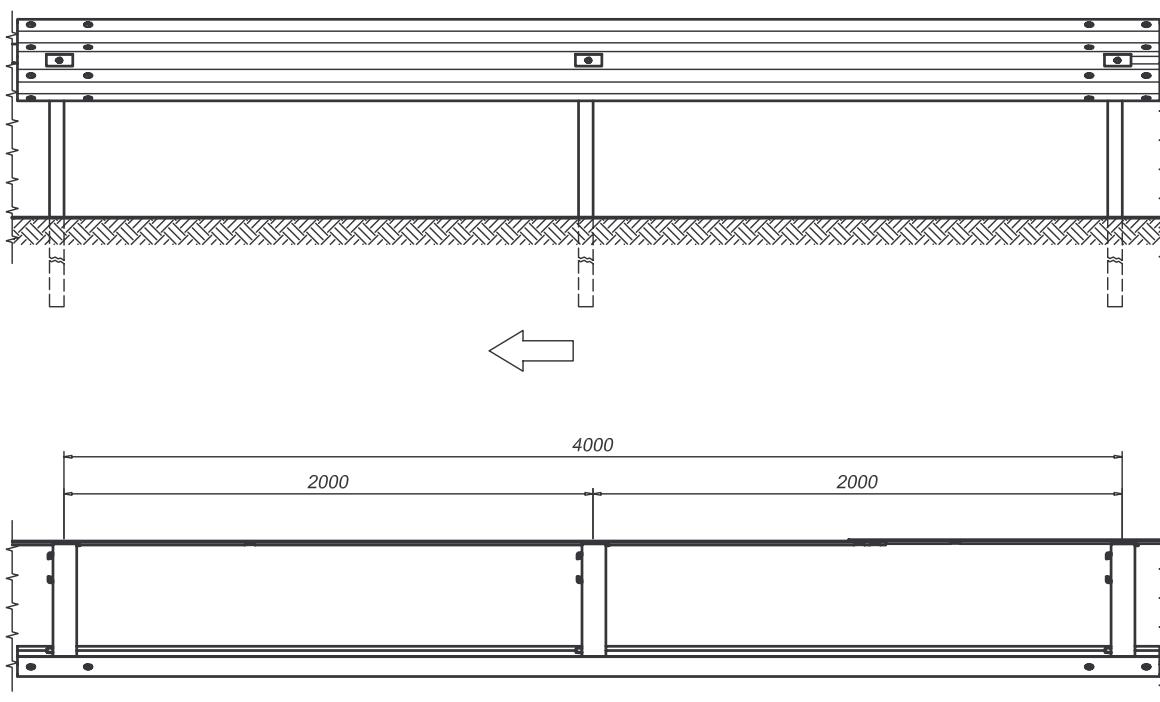

### Section

#### Description

1	SIGMA post 100x55x4,2 mm H=1900 mm
2	Aashto beam c/c 4000 mm th. 3,0 mm
3	Spacer 480X194 mm th. 3 mm with sleeve C114x69x24 L=130 mm th. 4 mm
4	Rear rail 70x5 mm L=4140 mm
5	Plate 100x45x5 mm

